

Implementation of two-factor authentication (MFA)

HAMK has introduced multifactor authentication(mfa) when logging into the services. Multifactor authentication has been implemented for information security reasons. This identification is done on the user's own device.

The multifactor authentication prevents e.g. data fishing. Authentication is asked again when there are changes in the network connection, or the mfa system (multifactor authentication) for some reason determines that a new confirmation is necessary.

1. Log in to aka.ms/mfasetup
2. Enter your HAMK username
 - Students: username@student.hamk.fi (hamk)
 - Students: username@student.hami.fi (hami)
 - Staff: username@hamk.fi

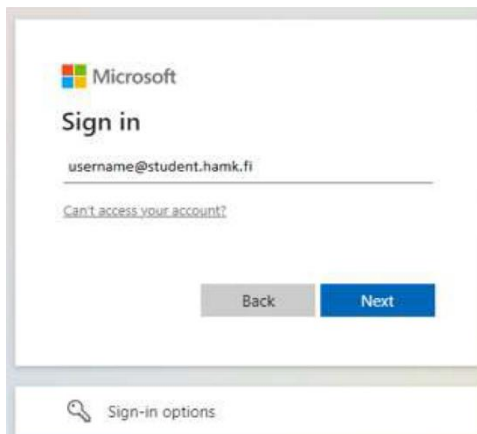

3. Press Next in the More information required window

4. Enter your password and press Sign in

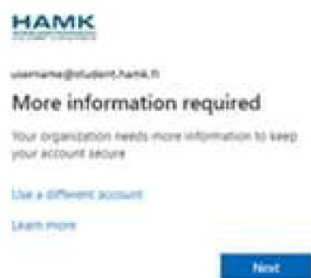

5. Select: I want to set up a different method. Press Next. (Let's first enable text message confirmation. At the end of the instructions, you can find instructions on other authentication methods).

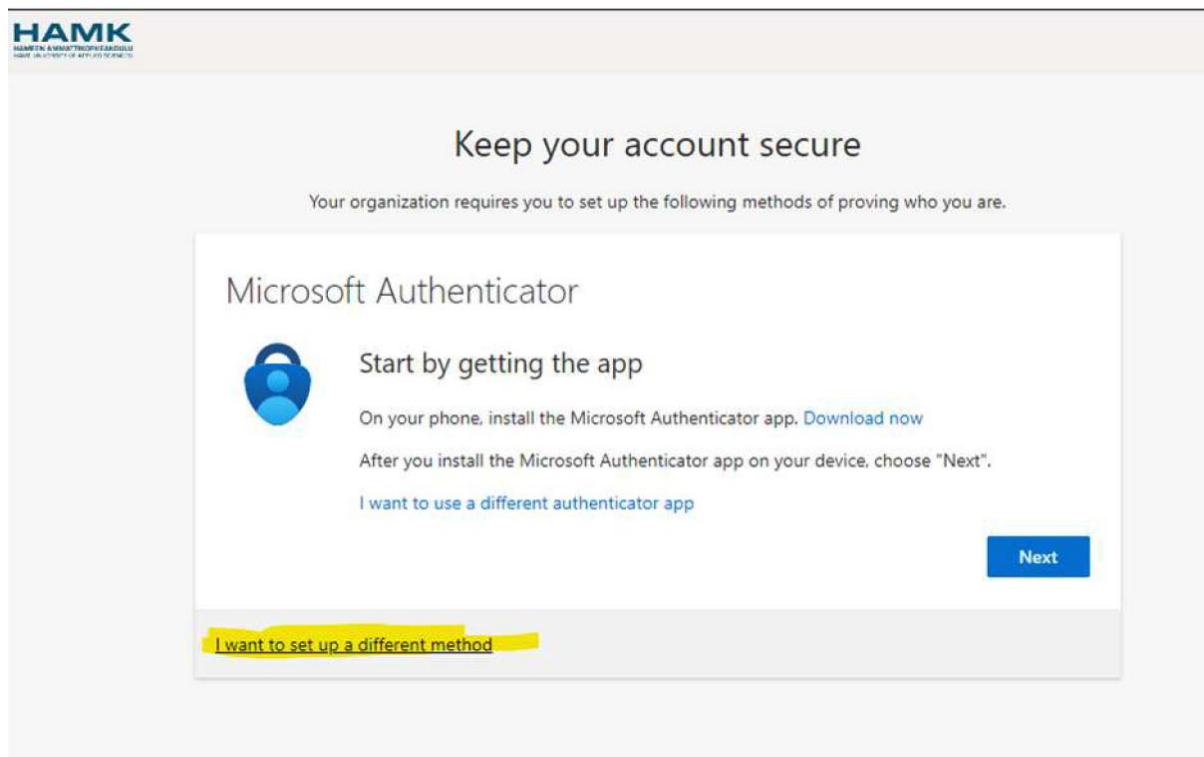

6. Select Phone. Make sure the country code setting is correct. Enter your phone number. Choose a text message (Text me a code) as the identification method. At a later stage, you can add other methods for two-factor authentication. After that, press Next.

Choose a different method ✕

Which method would you like to use?

Authenticator app

Phone

Office phone

Keep your account secure

Your organization requires you to set up the following methods of proving who you are.

Phone

You can prove who you are by answering a call on your phone or texting a code to your phone.

What phone number would you like to use?

Finland (+358)

Text me a code

Call me

Message and data rates may apply. Choosing Next means that you agree to the [Terms of service and Privacy and cookies statement](#).

[I want to set up a different method](#)

7. You will receive a text message on your phone, the code of which you must enter in the next step.

Keep your account secure

Your organization requires you to set up the following methods of proving who you are.

Phone

We just sent a 6 digit code to +358 . Enter the code below.

[Resend code](#)

[I want to set up a different method](#)

8. After this, you can access your own pages, your Security Info pages, and you have enabled two-step authentication with text message confirmation. If you want to use other authentication methods, go to section 9.

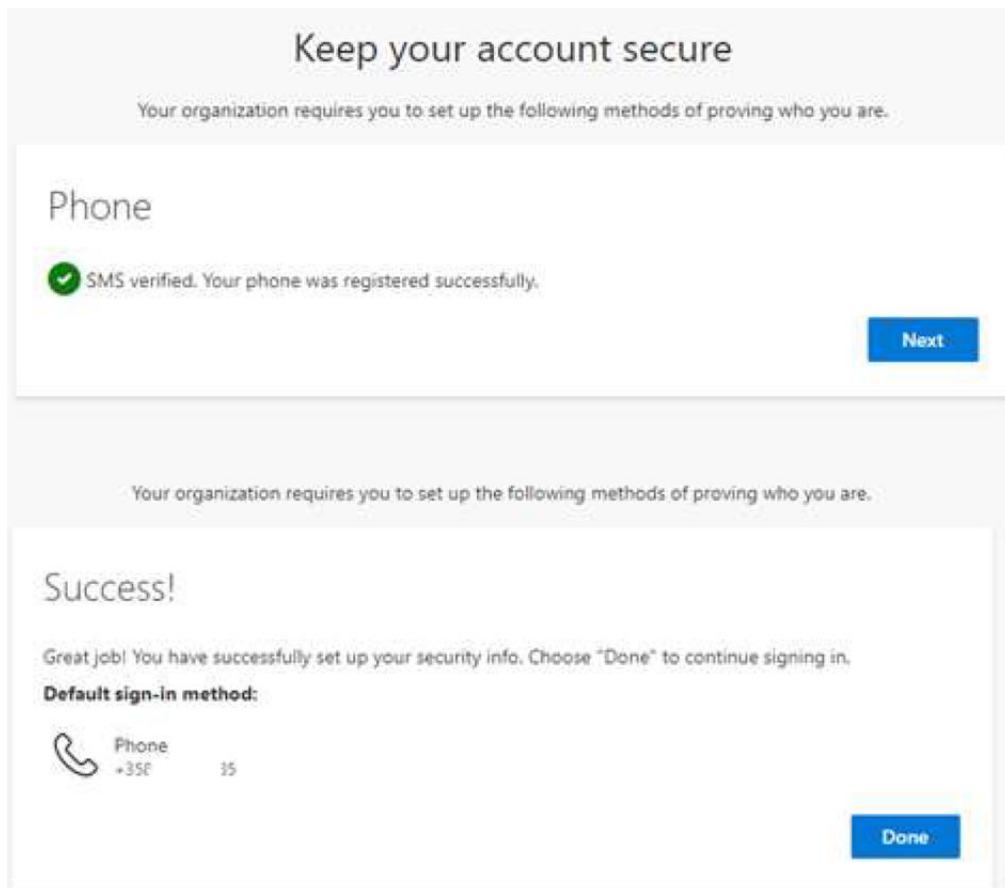

9. If you wish, you can now also add other methods for two-step authentication, such as another phone number (recommended), or use a separate authenticator application.

10. The implementation of the Microsoft authenticator is started by logging in to the page aka.ms/mfasetup - select +Add-sign-in-method Authenticator App

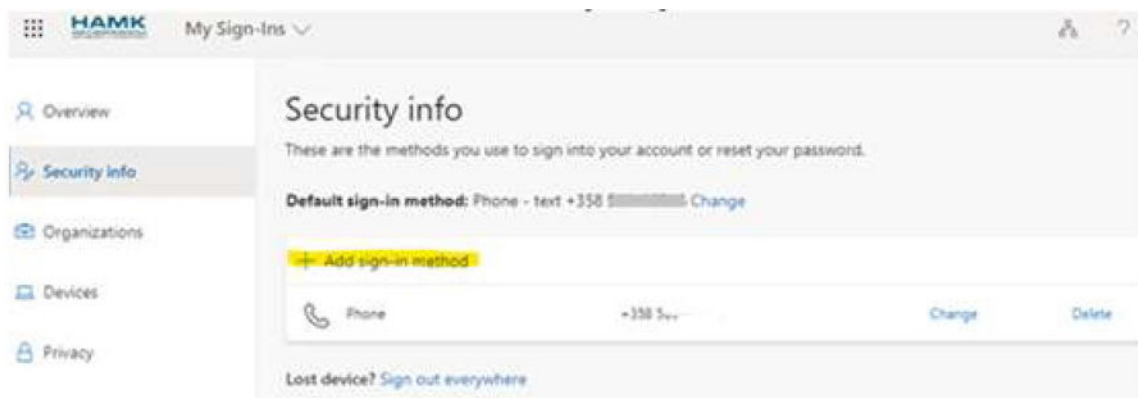

11. After installing the application, start it and add Work or school account from the + sign - scan the QR code of the mfasetup page with the application

